

GMLGX32 Multi-Roller Linear Slide

For Medium Load

Features

- The unique structure called "Dual X" allows for smooth movement even when the load is applied horizontally or vertically
- The rail is for medium load, designed to withstand an operating load of up to 300 N in either a horizontal or vertical direction
- Since there is no ball creep, it can be used together with a motor drive
- Moves smoothly even when moment load occurs
- Guide block is a preloaded type with minimal backlash

Notes

- Please use with stoppers
- Multiple guide blocks can be used in a guide rail



Dual X Structure

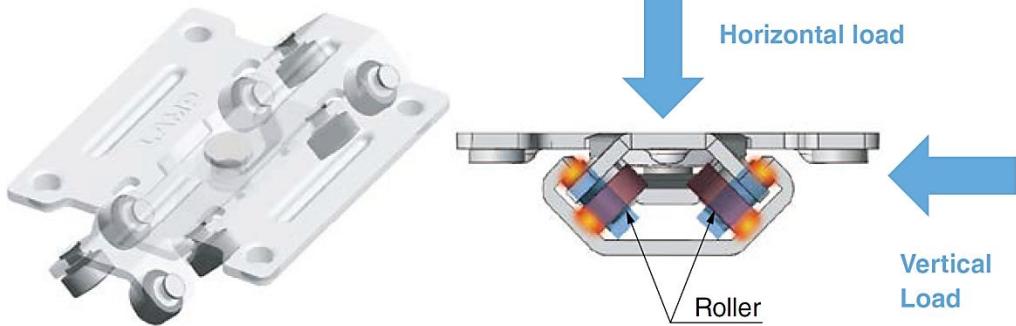

Rollers are located at two different angles to resist both horizontal and vertical loads

Mounting Direction

Can be mounted in the following directions

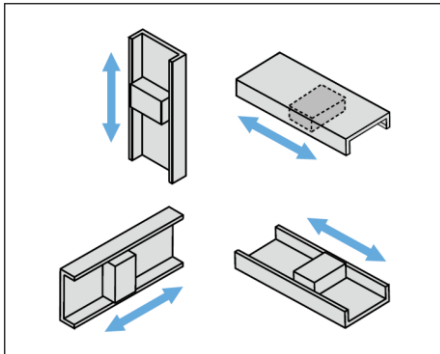

No Ball Creep



Ball creep² does not occur on roller slides, unlike ball bearing slides.

² A phenomenon where travel distances vary between outward and return paths due to a misaligned ball contact point that may occur depending on the smoothness of sliding or applied force when a ball type rail is moved. If extra load is applied in this state, the rail may become unable to move.

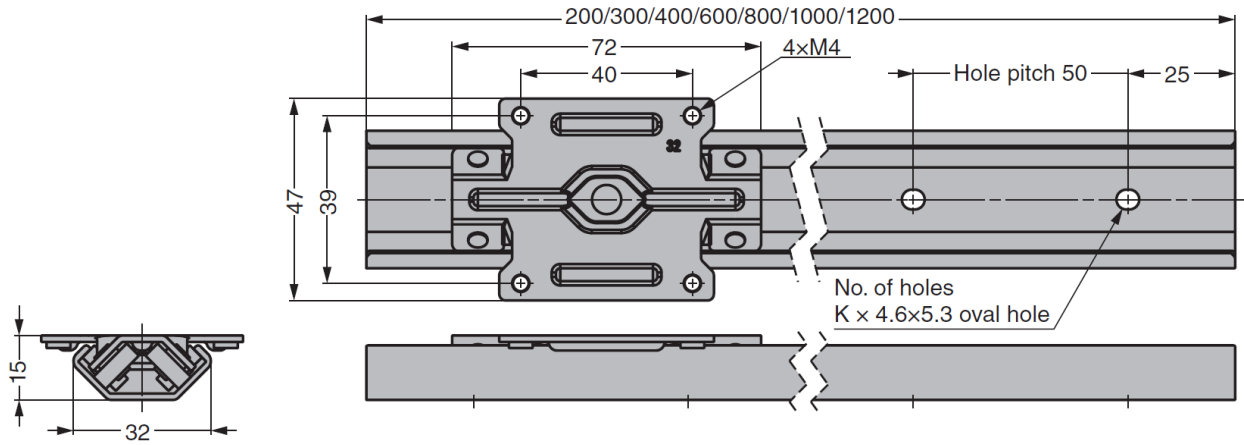

The figure shows the dimensions when the guide rail and a guide block are combined.

Rated Load Reference Values

Loading Direction	Horizontal Load Fx		Vertical Load Fy		Horizontal Load Fv	
	N	kgf	N	kgf	N	kgf
Max. Load Capacity	500	51.0	500	51.0	200	20.4
Operating Load	300	30.6	300	30.6	120	12.2

Loading Direction	Moment Mx		Moment My		Moment Mz	
	N.m	kgf.cm	N.m	kgf.cm	N.m	kgf.cm
Max. Moment	8.0	81.6	3.0	30.6	8.0	81.6
Operating Moment	4.8	48.9	1.8	18.3	4.8	48.9

Parallelism tolerance in motion

When travelling over a 200mm rail length, the variation is approximately 0.03mm in the vertical direction and 0.03mm in the horizontal direction.

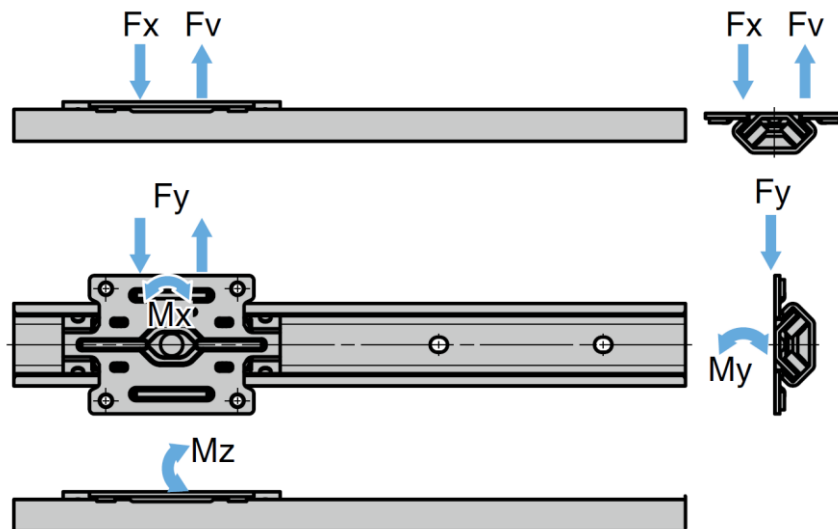

GMLGX32 Multi-Roller Linear Guide Rail

For Medium Load

Material

- Stainless steel 304

Notes

- Grease is applied to the rail. When applying additional grease, use lithium soap grease

Recommended Screw

- Hexagon socket bolt M4 (head diameter: 7.6 mm or less, head height: 2.2 mm or less)
- Pan head crew M4

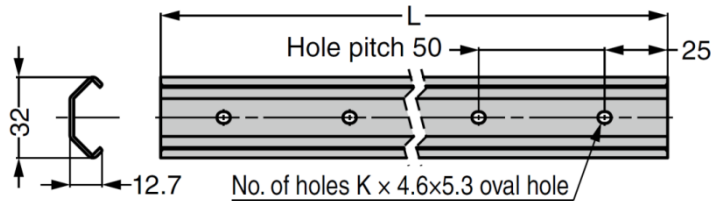

Part No.	Length (L)	No. of Holes (K)
GMLGX32-200S	200	4
GMLGX32-300S	300	6
GMLGX32-400S	400	8
GMLGX32-600S	600	12
GMLGX32-800S	800	16
GMLGX32-1000S	1000	20
GMLGX32-1200S	1200	24

GMLGX32-EC End Cap

For Medium Load

Features

- Prevents the guide block from falling off of the rail
- Protects the edge of the rail

Notes

- This product is not designed to stop or absorb impacts on the guide block
- Installation of this product will reduce the stroke by 4mm on each side
- Recommended tightening torque: 0.75 N·m

Recommended Screw

- Hexagon socket button head screw M4, or pan head screw M4 (used with a washer, outer diameter 8, thickness 0.8)



End Cap on Rail

Part No.	Material	Colour
GMLGX32-EC	Polyacetal (POM)	Black

GMLGX-32C-8 Multi-Roller Linear Guide Block

For Medium Load



Front



Back

Features

- Preloaded type with minimal backlash

Notes

- Rollers are made of steel
- Be cautious of rusting when exposed to hot and humid environments

No.	Product Name	Material
①	Mounting plate	Stainless Steel (SUS430)
②	Holding Plate	
③	Caulking Pin	Stainless Steel (SUS303)
④	Roller Pin	Stainless Steel (SUS XM7)
⑤	Bearing Roller	Steel

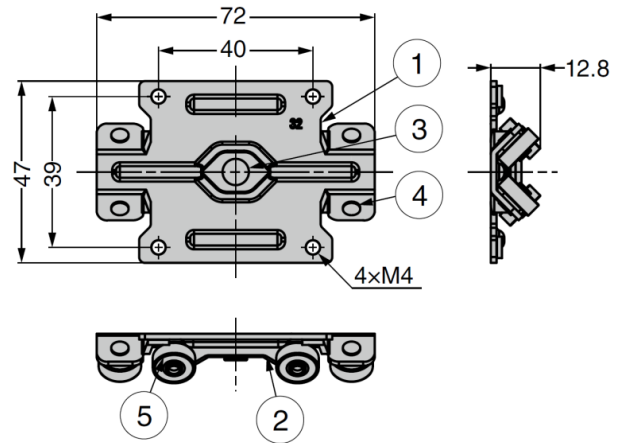

Part No.
GMLGX32C-8

Operating Load / Moment and Travel Distance (Life) Guidelines

Condition: 200 mm/sec of speed

